

Stainless Steel Cable Ties Bases

- **Material:** 316 Stainless Steel
- **Feature:** Fire and corrosion resistant
- **Application:** A strong cable tie mount, designed to accommodate a range of stainless steel cable ties
- **Operating Temperature:** - 80°C to +530°C

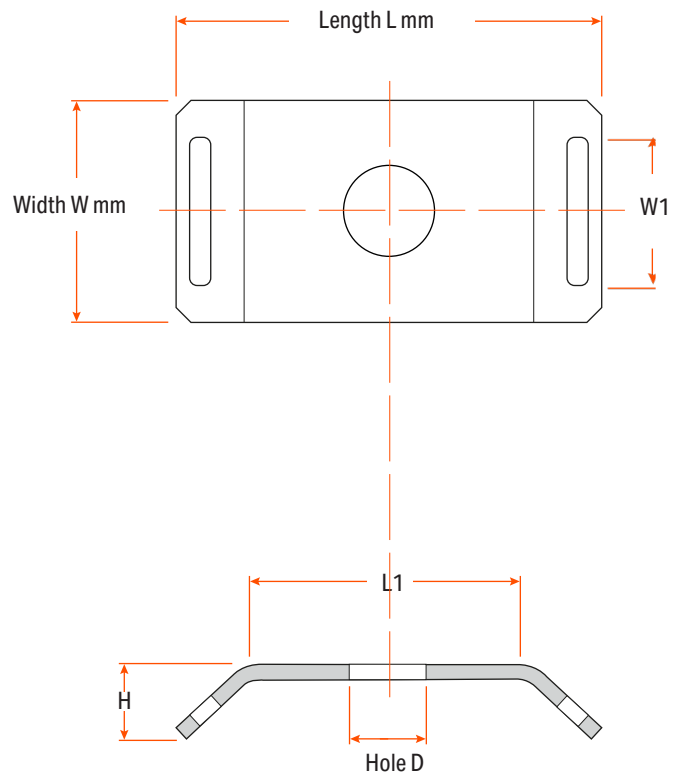

Item No.	Width W (mm)	Length L (mm)	Dimensions (mm)			Suitable for Max. Cable Tie Width (mm)	Hole D (mm)
			H	W1	L1		
CA16	15	29.2	5	10	18.8	10.0	4.2
CA17	15	29.2	5	10	18.8	10.0	6.2